



Close to the best life has to offer.



Srihti

Presenting luxury apartments at Srishti, Indirapuram.

Designed for happiness,
contentment, laughter, love,
luxury, fun and family.

And ready to move in.



Exceptional quality of life...
just a doorstep away.

Entertainment and shopping
at Shipra Mall – 500 mts.
Modern Education – 100 mts.
World-class healthcare – 2 kms.
Metro – 3 kms.
Delhi – 3 kms.

Luxury, prime location, a thriving upper class community, and the Shipra name, Srishti has everything that makes it a great place to call home. World-class facilities and amenities, well planned public access areas, thoughtfully designed and executed living spaces, and more. And everything one needs for modern city living is close at hand. Shopping and entertainment options, business and IT parks, and proximity to Delhi & NCR. Srishti promises a great way of living to a select few. Shouldn't you be here, too?



Life, upgraded.

Here, you can live the life you've always wanted. Your children can grow up happy and secure. Your wife will find everything she desires to make a house a home. All that you need to live well is within easy reach. Here, you will have life's finest moments. Srishti: the best life has to offer.



Luxury, quality and peace of mind at a single address.

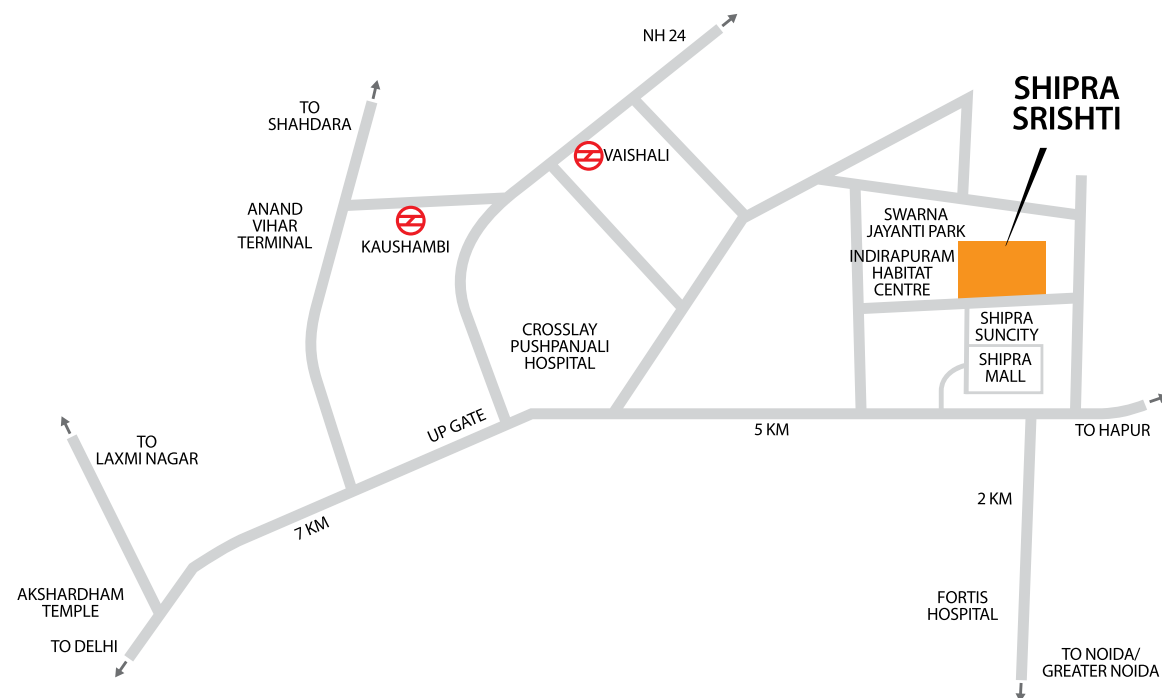

One of the highlights of Srishti is its location. A 12.5 acre luxury residential development next to Shipra Sun City, it offers 3 and 4 BHK apartments and penthouses with exceptional fittings and premium finishes.

- 2.6 acres of landscaped parks with lagoons, water cascade, pool deck
- 20,000 sq. ft. Clubhouse with international standard facilities
- Eco-friendly gardens with plantations
- Swimming pool complex with splash pool, spa, jacuzzi, party lawns
- Special play area for kids



Master Plan



FEATURES & AMENITIES

- | | | | |
|----|--------------------------|----|----------------------------------|
| 1 | Entrance Plaza | 13 | Reflexology Path (Jogging Track) |
| 2 | Watchman Cabin | 14 | Sand Pit |
| 3 | Drop-off Plaza | 15 | Seating Plaza |
| 4 | Swimming Pool | 16 | Tennis Court |
| 5 | Children's Pool | 17 | Mounds |
| 6 | Water Cascade | 18 | Flower Gardens |
| 7 | Pool Deck | 19 | Party Lawns |
| 8 | Trellis | 20 | Water Feature |
| 9 | Playground | 21 | Gazebo |
| 10 | Garden | 22 | Basketball Court |
| 11 | Yoga & Meditation Centre | 23 | Badminton Court |
| 12 | Study Corner | 24 | Cricket Net |
| | | 25 | Skating Rink |

Floor Plans

3 BHK + S - 2450 sq. feet
3 Bedroom, 3 Bathroom, Living & Dining,
Utility Area and S. Room



4 BHK + S - 3000 sq. feet
4 Bedroom, 4 Bathroom, Living & Dining,
Utility Area and S. Room

3 BHK + S - 2450 sq. feet
3 Bedroom, 3 Bathroom, Living & Dining,
Utility Area and S. Room

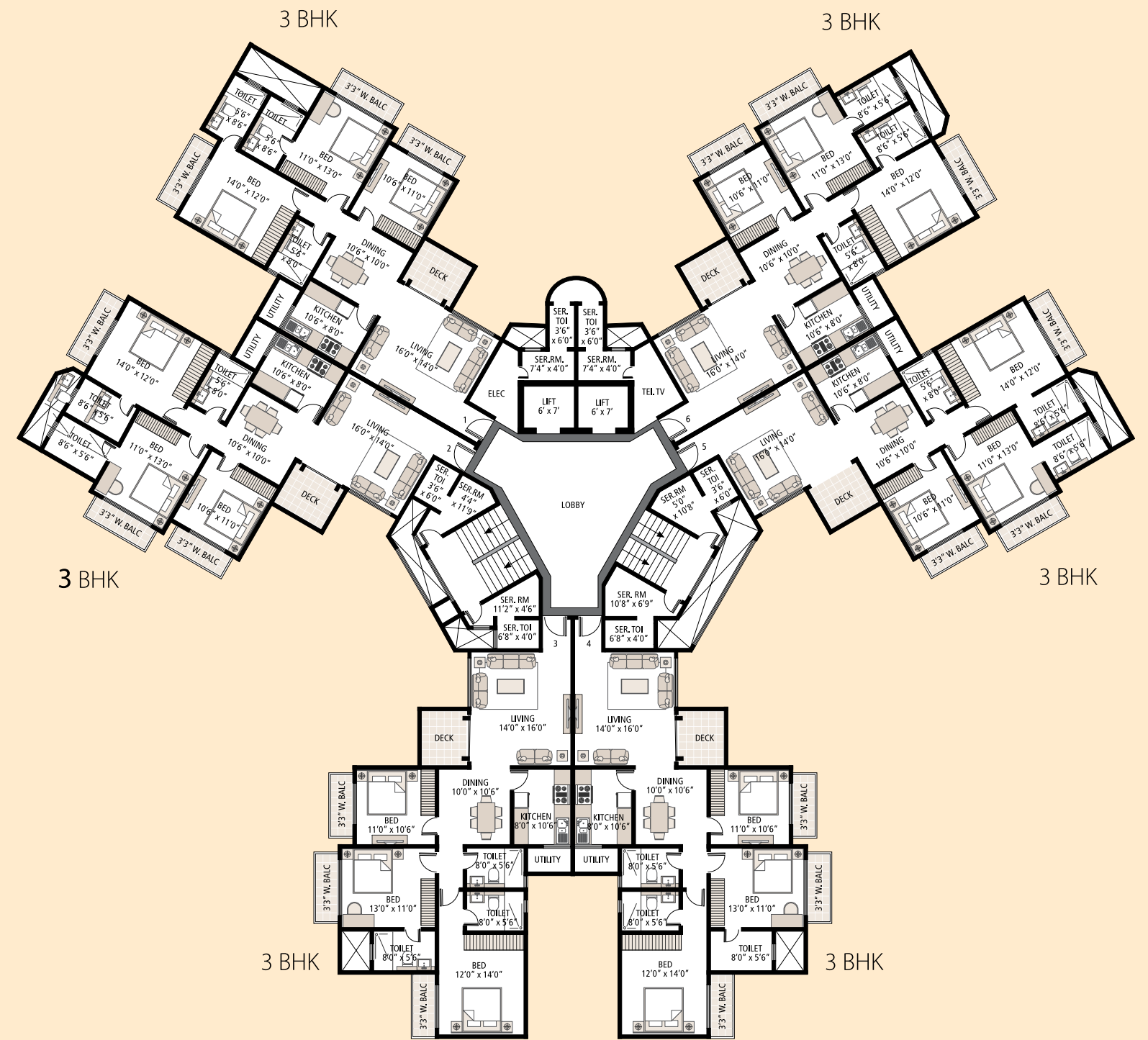

3 BHK + S - 1700 sq. feet
3 Bedroom, 3 Bathroom, Living & Dining,
Utility Area and S. Room



Proposed Specifications

WALL FINISH	
Internal Walls	Plastered, POP and Painted in Pastel Shades of Plastic Emulsion with white ceilings Textured paint
External Walls	
FLOORING	
Living & Dining	Vitrified Tiles
Bedrooms	Combination of Vitrified Tiles and Wooden Flooring
Balconies	Vitrified Tiles
Staircase	Kota Stone
WOODWORK	
	Wardrobes in all Bedrooms
TOILETS	
Walls	Printed Glazed Imported Ceramic Tiles Non-skid Ceramic Tiles Premium quality CP Fittings with Bath Tub (in one Toilet), Shower Panel, Towel Rail & Mirror
Flooring	
Fittings	
WINDOWS	
	UPVC Windows
KITCHEN	
Platform	Modular Kitchen Cabinets Working Platform in Granite Top with Stainless Kitchen Sink Ceramic Tiles above Working Platform Hot & Cold Supply with CP Fittings
Walls	
Fittings	
DOORS	
Hardware	Laminated Moulded Doors Brass Hardware with Chrome Polish, Brass Handles on Main Door
OTHERS	
Car Parking	Covered Car Parking Modular Switches, TV and Telephone Points in all Bedrooms and Living & Dining Room 24-Hour Treated Water Supply Back-up for each flat with extra charges Security arrangements like CCTV, Intercom Facility
Electrical	
Water Supply	
Power back-up	
Security	

1 sq. metre = 1.196 sq. yard & 1 sq. metre = 10.76 sq. feet. In the interest of maintaining high standards, all floor plans, layout plans, areas, dimensions and specifications are indicative and are subject to change as decided by the company or by any competent authority. Soft furnishing, cupboards, furniture and gadgets are not part of the offering.

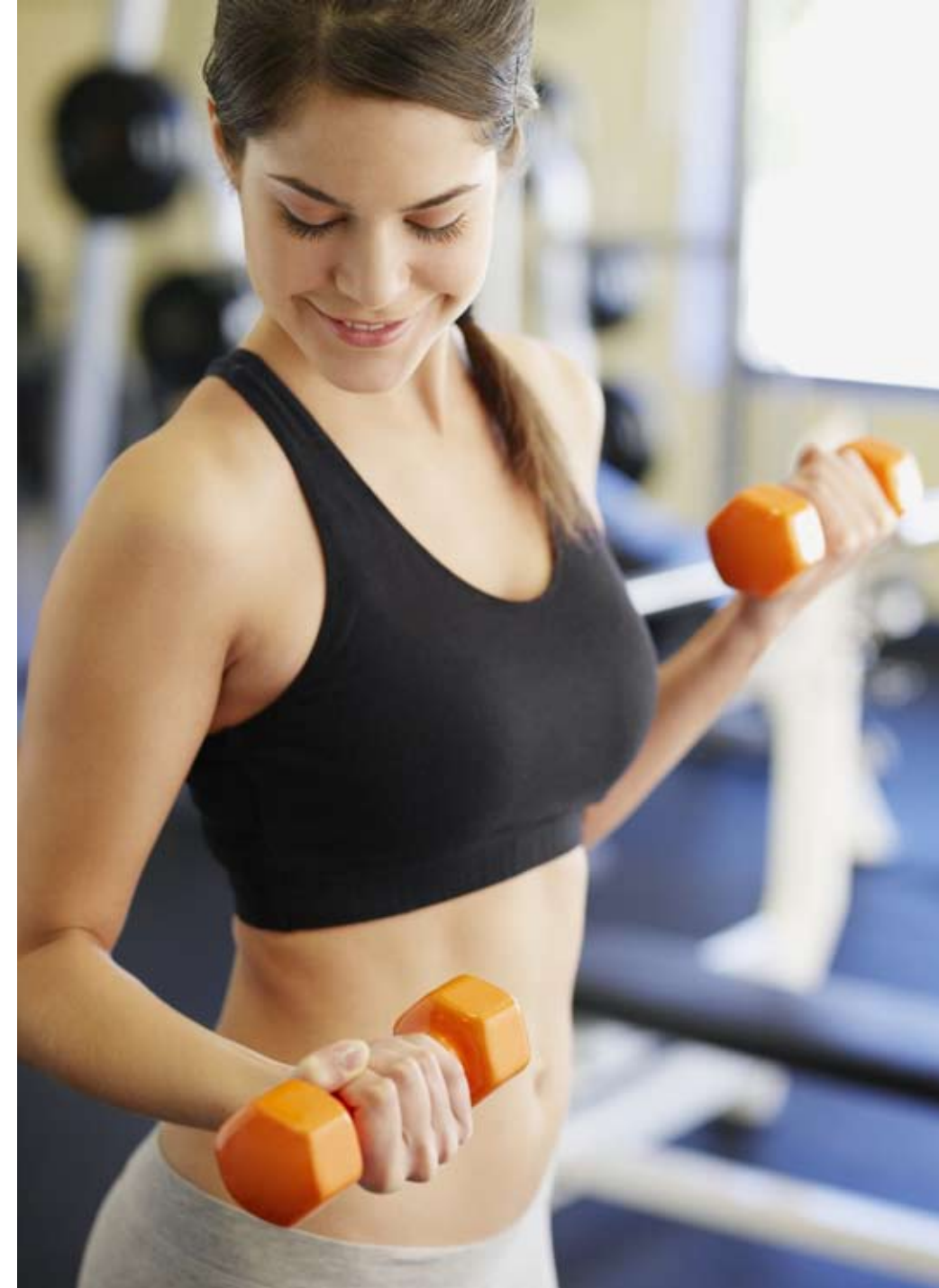



& JAI KRISHAN ESTATES DEVELOPERS PVT. LTD.

For any enquiries about our projects please call:

(+91 120) 2651950 - 52

E-mail: sales@shipraworld.com | SMS: SHIPRAWORLD to 56677

www.shipraworld.com | www.srishtishipra.com



Corporate Office: Plot No 9, Vaibhav Khand, Shipra Mall, Indrapuram, Ghaziabad. UP - 201 012. India.